

- |      |           |   |
|------|-----------|---|
| Pos. | ArtNr.    |   |
| 10   | HR6015658 | R |
| 20   | FM200     |   |
| 30   | HG6015625 |   |
| 40   | HG6015695 | R |
| 60   | FM200     |   |
| 90   | W253778   | L |
| 100  | U507803   |   |
| 110  | TB5078    |   |
| 125  | RW-CLIP   |   |
| 130  | TB5078    |   |
| 140  | TB5078    |   |
| 160  | U16.0161  | R |
| 170  | UP907801  |   |
| 180  | DM607807  |   |
| 190  | UP6050    | R |
| 210  | US607840  |   |
| 220  | U607877   | L |
| 290  | O403901   | L |
| 300  | O403901   | L |
| 310  | O403901   | L |
| 320  | O403901   | L |
| 330  | W163739   |   |
| 340  | OK903911  |   |
| 350  | OK903911  |   |
| 360  | W163739   |   |

16

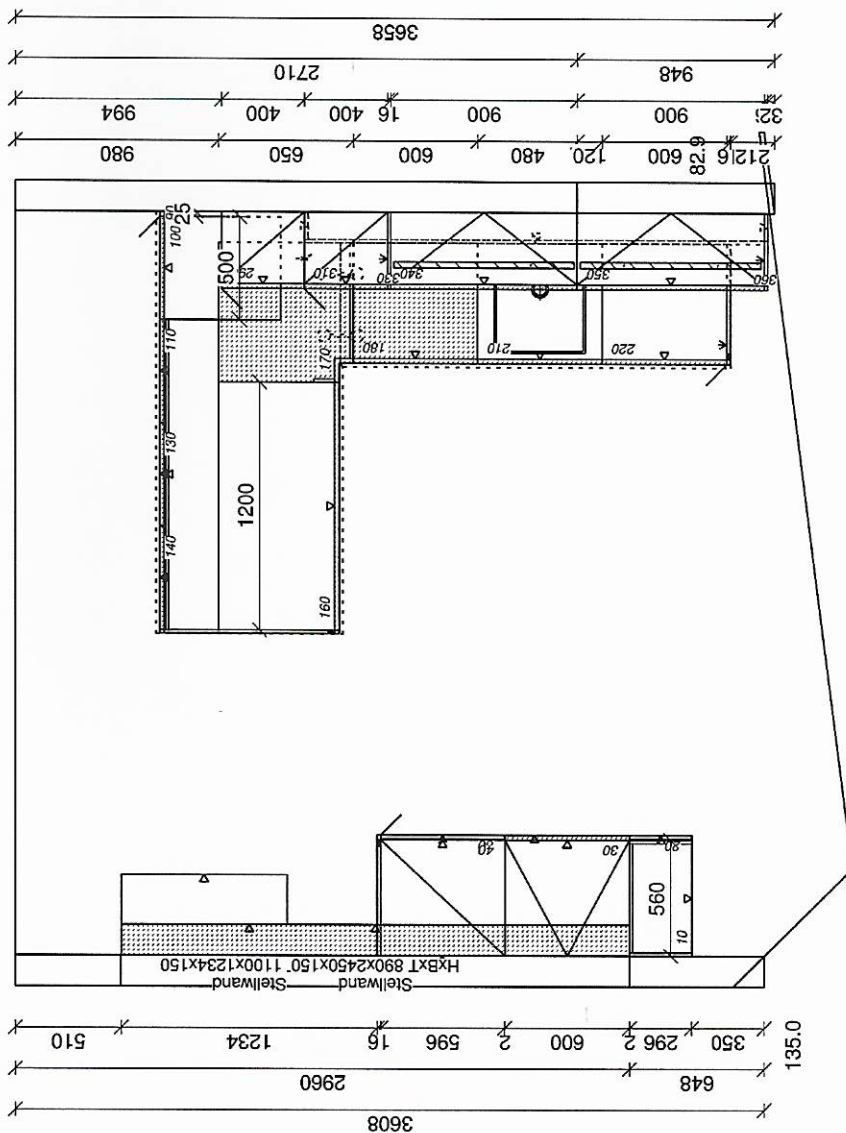

127.9

**Häcker**  
kitchen. german made.  
Werkstrasse 3  
D-32289 Rüdighausen  
Tel. 05746 / 940-0

AV 2065 satin Schichtst.

A678 AV 2065 satin Schichtst.

GP: M – mittig

GB: 495 – Griff 192mm edelstahlfarben

Name : B&S KüchenTreff GmbH

Ort : Thymau

KD-Nr : 12818

Riß  
GR

Maßstab  
1:33

Kom.-Name: AUSSTELLUNG KOJE 2

Kom.-Nr: 115691/2

AB-NR.  
16867337

DATUM  
05.12.2016

Tel:

SB: